



LET'S DIGITALIZE YOUR SUSTAINABLE FUTURE WITH AXILE MACHINE

www.axilemachine.com





CONTENTS

- 02 AXILE Introduction
- 03 AXILE Sustainability
- 04 Comprehensive Service
- 05 AXILE Digitalization
- 06 Machines Technical Data
- 15 Digital Intelligent Automation

AXILE INTRODUCTION

AXILE designs and builds agile smart 5-axis VMCs with leading digitalized automation solutions for manufacturers of complex parts and components to embrace industry 4.0 while creating a sustainable operating business model.

AXILE is actively integrating sustainability principles into its business model and keeps investing in R&D, focusing on supplying flexible & sustainable manufacturing solutions to boost productivity and profitability.

We believe that only by embracing digitalization, our customers will achieve a pledge of sustainable development respectful of people and the environment with the necessary competitiveness to ensure the survival of their business.

AXILE digitalization was launched for an optimized machine monitoring and a better energy-saving management compliant with ISO 14955. We aim to help our customers to be prepared for the challenges of the power consumption reduction and to mitigate the carbon emission taxes generated by the manufacturing process.

Agile Smart Machining is a promise from AXILE to manufacturers to make industry 4.0 a reality. We developed this all-new approach to bring manufacturers significantly shorter processing times, flexible and optimized production, zero unscheduled downtime, and most importantly, a way to operate without wasting resources.



ART™

DIGITALIZED INTELLIGENT AUTOMATION

*Reduction of Energy Consumption & Carbon Emissions
Machine Failure Prediction
Zero Unplanned Downtime*



AXILE SUSTAINABILITY

At AXILE, we are dedicated to revolutionizing the manufacturing industry through the integration of digital management, sustainable Environmental, Social, and Governance (ESG) practices, compliance with ISO14955, and driving the energy transition.

Digital Management Powering Manufacturing Excellence

With a focus on powering manufacturing excellence, we leverage cutting-edge technologies to optimize operations, enhance productivity, and enable data-driven decision-making. Our digital management solutions empower businesses with real-time data monitoring, predictive maintenance, and remote-control capabilities. By embracing digitalization, manufacturers can achieve operational efficiency, adapt to market demands, and unlock new avenues for growth.

Sustainable ESG Practices Shaping a Better Future

Sustainability is at the core of our operations. We prioritize energy efficiency, waste reduction, and eco-

friendly manufacturing practices to minimize our environmental impact. We actively support the energy transition by promoting renewable energy sources, reducing carbon emissions, and embracing sustainable solutions throughout our value chain.

AXILE is proud to be ISO14955 compliant, adhering to international standards for sustainability, environmental management, and social responsibility. We strive to exceed these standards, constantly seeking innovative ways to improve our practices and contribute to a greener and more sustainable future.

Join us in Our Vision

Join us on a transformative journey where digitalization, sustainability, ISO14955 compliance, and energy transition converge. Together, we can drive manufacturing excellence, promote environmental stewardship, achieve social responsibility, and accelerate the energy transition. Experience the power of digital innovation and sustainable practices with AXILE as we shape a brighter and more sustainable future for the manufacturing industry.



COMPREHENSIVE SERVICE

Quality and Service build our business !

Here at AXILE, we are always ready to assist you in optimizing your machining applications, offering the expertise to improve the quality and speed of your simultaneous 5-axis machine process.

Here at AXILE, we're always ready to assist you in optimizing your machining applications, offering the expertise to augment your command of simultaneous 5-axis machining.

Our team of experienced and technically savvy distributors is the first line of support for your technical queries.

AXILE has comprehensive online, technical documentation ready for machine owners and will reply to any queries about documented specifications, functions, and parameters within 24 hours.

Our 5axis machining center range is supported by local and quickly available storage of spare parts which will help enhance your machine shop with improved machine availability.

Data sharing and cyber security are important. The ART adapts OPC UA, a data exchange communication standard developed for Industry 4.0 applications, to secure the framework of industrial interoperability. The sensitive information (based on machine sensor data feedback) is stored and protected in our ART™ Cloud system. By Connecting your ART cloud with the AXILE technical support team, customers will obtain the various benefits and speed up the maintenance service they expect.

We are proud of our experienced local service and support required to achieve smooth and reliable operations for the long haul - helping you to reach your production goals!



AXILE DIGITALIZATION

To deliver agile smart machining and that all-important competitive edge, we have created an ART™ system that enables 24/7 automated production and allows operators to manage digitally, enabling them to plan and strategize through data analysis.

ART™ monitors all the wearing components, energy consumption, and fluids such as lubricant and coolant to supply real-time status updates on the machine and its components and to pre-empt future issues. AXILE's ART™ empowers manufacturers to make informed decisions, optimizing operations and greatly improving production efficiency. Now, that's how AXILE sees smart manufacturing in meeting the needs of sustainable business operations.

1. Reliability Maintenance

Unexpected downtime is the enemy of profitability. ART™ delivers machine components diagnosis, machine lifetime estimation, and consumable supplies monitoring to prevent machine failure and eliminate unplanned downtime.

2. Manufacturing Process

Knowledge is power. ART™ achieves superior data collection and analytics on machine status and utilization rate, to deliver real-time information for optimized production strategies.

3. Energy Management

Every penny counts. ART™ enables manufacturers to monitor their power consumption, to identify ways to maximize energy efficiency and reduce expenditure.

4. Intelligent Management

ART™ provides analytic information for managers to understand the machine performance and take immediate actions to optimize the machine capability.

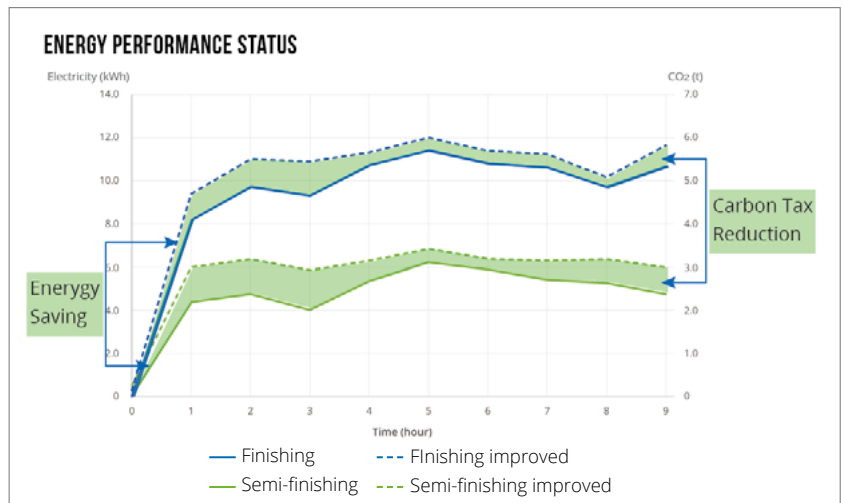
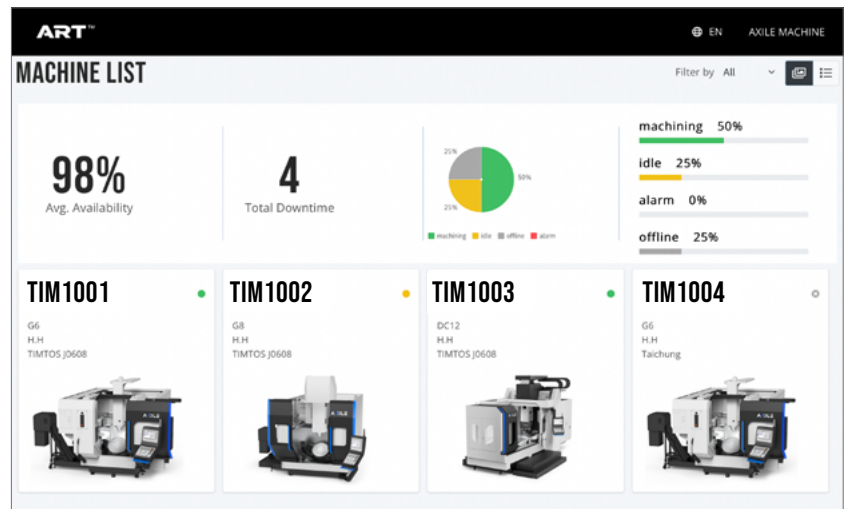

The above graph shows the power consumption (left) and its equivalent carbon emissions (right) during finishing and semi-finishing tasks. The task curve lines show improved energy performance after adjusting the machine's daily operation.

MACHINE TECHNICAL DATA

V5X/V5Xi* (STANDARD VERSION)



Workpiece size

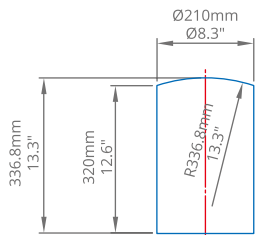

Table size 170 mm | 6.7 in

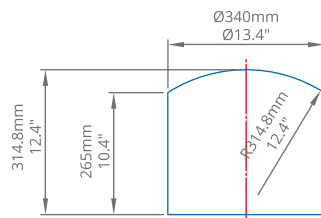

Table size 200 mm | 7.87 in

Table size	Ø170 mm Ø6.7 in Ø200 mm Ø7.87 in
Max. table load	30 kg 66.14 lbs 50 kg 110.23 lbs
A range (swiveling)	±120 deg
C (rotary)	360 deg
Max. swivelling (A) speed	100 rpm
Max. rotary (C) speed	200 rpm
X travel	600 mm 23.6 in
Y travel	500 mm 19.7 in
Z travel	465 mm 18.3 in 440 mm 17.3 in
Max feedrate X/Y/Z	40 m/min 1575 in/min
Spindle speed	12000 rpm (std.)
Spindle taper	ISO40 (std.)
Magazine positions	32T/40T
Control unit	<ul style="list-style-type: none"> · Heidenhain TNC640 · Heidenhain TNC7 · Siemens SINUMERIK ONE · Fancuc 31i-B5 plus iHMI pro

* "i" stands for Industry 4.0 and Intelligent management. AXILE offers the "i" machine versions equipped with ART digital technology to embrace smart manufacturing and digital intelligent management in order to stay agile in a fast changing environment.

MACHINE TECHNICAL DATA

V5X/V5Xi* (GRAPHITE VERSION)

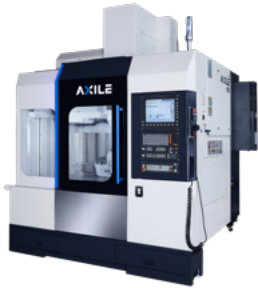

Workpiece size

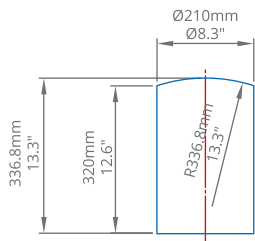

Table size 170 mm | 6.7 in

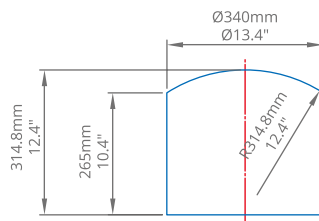

Table size 200 mm | 7.87 in

Table size	Ø170 mm Ø6.7 in Ø200 mm Ø7.87 in
Max. table load	30 kg 66.14 lbs 50 kg 110.23 lbs
A range (swiveling)	±120 deg
C (rotary)	360 deg
Max. swivelling (A) speed	100 rpm
Max. rotary (C) speed	200 rpm
X travel	600 mm 23.6 in
Y travel	500 mm 19.7 in
Z travel	435 mm 17.1 in 410 mm 16.1 in
Max feedrate X/Y/Z	40 m/min 1575 in/min
Spindle speed	25000 rpm (std.)
Spindle taper	HSK E50 (std.)
Magazine positions	32T/40T
Control unit	<ul style="list-style-type: none"> · Heidenhain TNC640 · Heidenhain TNC7 · Siemens SINUMERIK ONE · Fanuc 31i-B5 plus iHMI pro

* "i" stands for Industry 4.0 and Intelligent management. AXILE offers the "i" machine versions equipped with ART digital technology to embrace smart manufacturing and digital intelligent management in order to stay agile in a fast changing environment.

DC4/DC4i*



Workpiece size

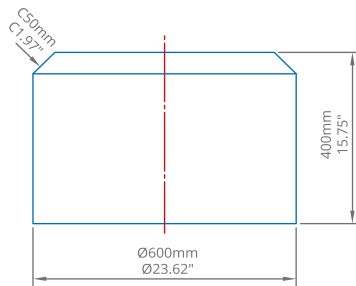

Table size	Ø400 mm 15.75in
Max. table load	300 kg 661.38 lbs
A range (Swiveling)	±180 deg
C (Rotary)	360 deg
X travel	685 mm 26.97 in
Y travel	670 mm 26.38 in
Z travel	400 mm 15.75 in
Max feedrate X/Y/Z	36 m/min 1417.3 in/min
Spindle speed	20000 rpm (std.)
Spindle taper	HSK A63 (std.)
Magazine positions	80T
Control unit	<ul style="list-style-type: none">· Heidenhain TNC640· Heidenhain TNC7· Siemens SINUMERIK ONE· Fanuc 31i-B5 plus iHMI pro

* "i" stands for Industry 4.0 and Intelligent management. AXILE offers the "i" machine versions equipped with ART digital technology to embrace smart manufacturing and digital intelligent management in order to stay agile in a fast changing environment.

MACHINE TECHNICAL DATA

G6/G6i*



Workpiece size

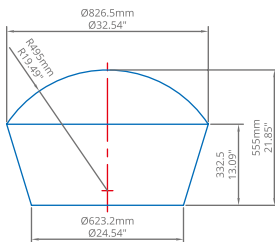
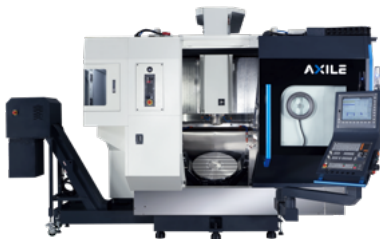

Table size	Ø600 mm Ø23.6 in
Max. table load	600 kg 1323 lbs
A range (swiveling)	±120 deg
C (rotary)	360 deg
Max. swivelling (A) speed	100 rpm
Max. rotary (C) speed	200 rpm
X travel	650 mm 25.6 in
Y travel	850 mm 33.5 in
Z travel	500 mm 19.7 in
Max feedrate X/Y/Z	36 m/min 1417 in/min
Spindle speed	20000 rpm (std.)
Spindle taper	HSK-A63 (std.)
Magazine positions	80T/120T
Control unit	<ul style="list-style-type: none"> · Heidenhain TNC640 · Heidenhain TNC7 · Siemens SINUMERIK ONE · Fanuc 31i-B5 plus iHMI pro

G6 MT/G6i* MT



Workpiece size

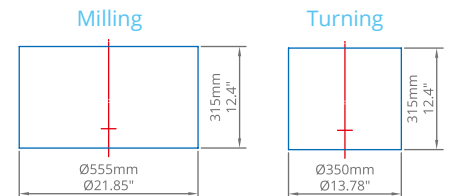
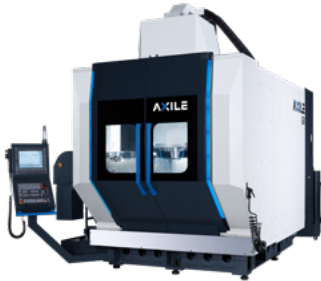

Table size	Ø500 mm Ø19.7 in
Max. table load (Turning)	350 kg 771 lbs
Max. table load (Milling)	500 kg 1102 lbs
Spindle taper	HSK-T63 (std.)
Max. swivelling (A) speed (Turning)	15 rpm
Max. swivelling (A) speed (Milling)	100 rpm
Max. rotary (C) speed (Turning)	1500 rpm
Max. rotary (C) speed (Milling)	100 rpm

* "i" stands for Industry 4.0 and Intelligent management. AXILE offers the "i" machine versions equipped with ART digital technology to embrace smart manufacturing and digital intelligent management in order to stay agile in a fast changing environment.

G8/G8i*



Workpiece size

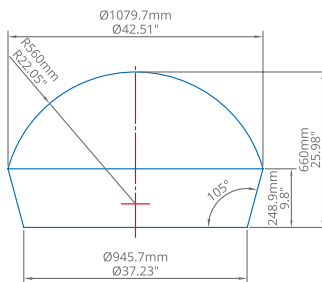
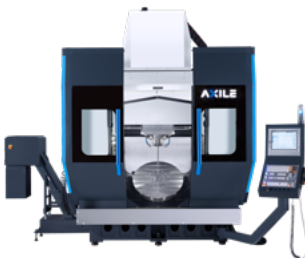

Table size	Ø800 mm Ø31.5 in
Max. table load	1300 kg 2866lbs
A range (swiveling)	±120 deg
C (rotary)	360 deg
Max. swivelling (A) speed	80 rpm
Max. rotary (C) speed	100 rpm
X travel	670 mm 26.4 in
Y travel	820 mm 32.3 in
Z travel	600 mm 23.6 in
Max feedrate X/Y/Z	60 m/min 2362 in/min
Spindle speed	20000 rpm (std.)
Spindle taper	HSK-A63 (std.)
Magazine positions	32T/64T,48T/96T,60T/120T
Control unit	<ul style="list-style-type: none"> · Heidenhain TNC640 · Heidenhain TNC7 · Siemens SINUMERIK ONE · Fanuc 31i-B5 plus iHMI pro

G8 MT/G8i* MT



Workpiece size

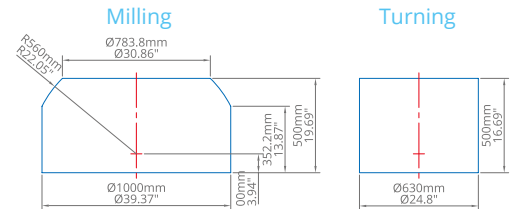
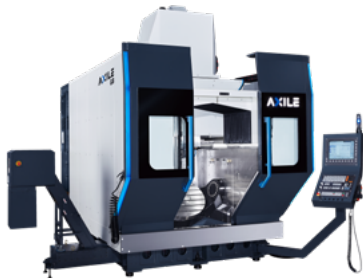

Table size	Ø800 mm Ø31.5 in
Max. table load (Turning)	850 kg 1873 lbs
Max. table load (Milling)	1200 kg 2645 lbs
Spindle taper	HSK-T63 (std.)
Max. swivelling (A) speed (Turning)	15 rpm
Max. swivelling (A) speed (Milling)	100 rpm
Max. rotary (C) speed (Turning)	1000 rpm
Max. rotary (C) speed (Milling)	100 rpm

* "i" stands for Industry 4.0 and Intelligent management. AXILE offers the "i" machine versions equipped with ART digital technology to embrace smart manufacturing and digital intelligent management in order to stay agile in a fast changing environment.

MACHINE TECHNICAL DATA

G10/G10i*



Workpiece size

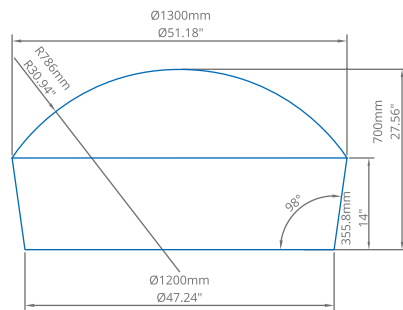
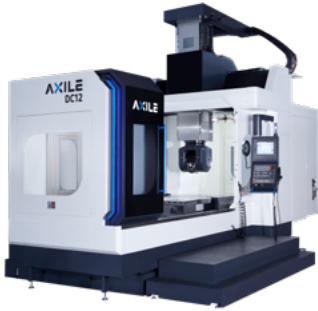

Table size	Ø1000 mm Ø39.4 in
Max. table load	2000 kg 4409 lbs
A range (swiveling)	±120 deg
C (rotary)	360 deg
Max. swivelling (A) speed	80 rpm
Max. rotary (C) speed	100 rpm
X travel	1000 mm 39.4 in
Y travel	1100 mm 43.3 in
Z travel	750 mm 29.5 in
Max feedrate X/Y/Z	36 m/min 1417 in/min
Spindle speed	20000 rpm (std.)
Spindle taper	HSK-A63 (std.)
Magazine positions	32T/64T,48T/96T,60T/120T
Control unit	· Heidenhain TNC640 · Heidenhain TNC7 · Siemens SINUMERIK ONE · Fanuc 31i-B5 plus iHMI pro

* "i" stands for Industry 4.0 and Intelligent management. AXILE offers the "i" machine versions equipped with ART digital technology to embrace smart manufacturing and digital intelligent management in order to stay agile in a fast changing environment.

DC12/DC12i*



Workpiece size

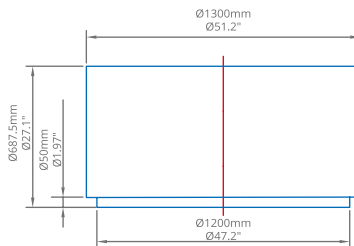

Table size	2200x1200 mm 86.6x47.2 in
Max. table load	2500 kg 5511 lbs
Rotary table top	Ø1200 mm Ø47.2 in
B range (Swiveling)	±110 deg
C (Rotary)	360 deg
X travel	2200 mm 86.6 in
Y travel	1400 mm 55.1 in
Z travel	1000 mm 39.4 in
Max feedrate X/Y/Z	36 m/min 1417 in/min
Spindle speed	20000 rpm (std.)
Spindle taper	HSK-A63 (std.)
Magazine positions	90T/120T
Control unit	<ul style="list-style-type: none"> · Heidenhain TNC640 · Heidenhain TNC7 · Siemens SINUMERIK ONE · Fanuc 31i-B5 plus iHMI pro

DC12 MT/DC12i* MT



Workpiece size

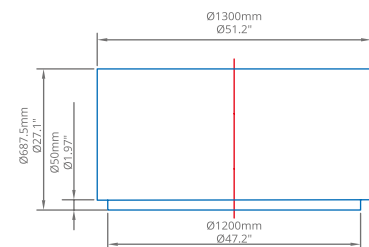

Table size	2200x1200 mm 86.6x47.2 in
Max. table load	2500 kg 5511 lbs
Spindle speed	20000 rpm
Spindle taper	HSK-T63
Max. rotary (C) speed (Turning)	800 rpm
Max. rotary (C) speed (Milling)	100 rpm

* "i" stands for Industry 4.0 and Intelligent management. AXILE offers the "i" machine versions equipped with ART digital technology to embrace smart manufacturing and digital intelligent management in order to stay agile in a fast changing environment.

V4/V4i*



Workpiece size	600x400x450 mm 23.62x15.75x17.72 in
Table size	770x410 mm 30.31x16.14 in
Max. table load	400 kg 881.85 lb
X travel	600 mm 23.62 in
Y travel	400 mm 15.75 in
Z travel	450 mm 17.72 in
Max feedrate X/Y/Z	36 m/min 1417 in/min
Spindle speed	12000 rpm (std.)
Spindle taper	ISO40 (std.)
Linear guideways type	Ball type
Magazine positions	30T/40T
Control unit	<ul style="list-style-type: none">· Heidenhain TNC640· Heidenhain TNC7· Siemens SINUMERIK ONE· Fanuc 31i-B plus

V5/V5i*



Workpiece size	800x500x500 mm 23.62x15.75x17.72 in
Table size	900x520 mm 30.31x16.14 in
Max. table load	600 kg 1322.77 lb
X travel	800 mm 23.62 in
Y travel	500 mm 15.75 in
Z travel	500 mm 17.72 in
Max feedrate X/Y/Z	36 m/min 1575 in/min
Spindle speed	12000 rpm (std.)
Spindle taper	ISO40 (std.)
Linear guideways type	Roller type
Magazine positions	30T/40T
Control unit	<ul style="list-style-type: none">· Heidenhain TNC640· Heidenhain TNC7· Siemens SINUMERIK ONE· Fanuc 31i-B plus

* "i" stands for Industry 4.0 and Intelligent management. AXILE offers the "i" machine versions equipped with ART digital technology to embrace smart manufacturing and digital intelligent management in order to stay agile in a fast changing environment.

V6/V6i*

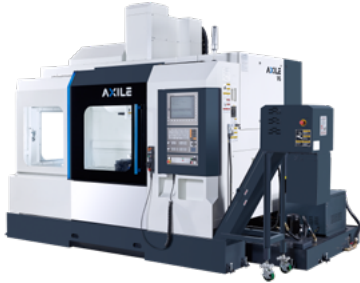

Workpiece size	1050x600x600 mm 41.3x23.6x23.6 in
Table size	1200x600 mm 47.2x23.6 in
Max. table load	800 kg 1763.7 lb
X travel	1050 mm 41.3 in
Y travel	600 mm 23.6 in
Z travel	600 mm 23.6 in
Max feedrate X/Y/Z	40 m/min 1574.8 in/min
Spindle speed	12000 rpm (std.)
Spindle taper	ISO40 (std.)
Linear guideways type	Roller type
Magazine positions	30T/40T
Control unit	<ul style="list-style-type: none">· Heidenhain TNC640· Heidenhain TNC7· Siemens SINUMERIK ONE· Fanuc 31i-B plus

V7/V7i*

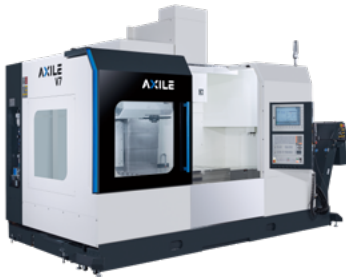

Workpiece size	1200x730x650 mm 47.2X28.7X25.6 in
Table size	1400x710 mm 55.1X27.6 in
Max. table load	1000 kg 2204.6 lb
X travel	1200 mm 47.2 in
Y travel	730 mm 28.7 in
Z travel	650 mm 25.6 in
Max feedrate X/Y/Z	40 m/min 1574.8 in/min
Spindle speed	12000 rpm (std.)
Spindle taper	ISO40 (std.)
Linear guideways type	Roller type
Magazine positions	30T/40T
Control unit	<ul style="list-style-type: none">· Heidenhain TNC640· Heidenhain TNC7· Siemens SINUMERIK ONE· Fanuc 31i-B plus

* "i" stands for Industry 4.0 and Intelligent management. AXILE offers the "i" machine versions equipped with ART digital technology to embrace smart manufacturing and digital intelligent management in order to stay agile in a fast changing environment.

DIGITAL INTELLIGENT AUTOMATION

AXILE digitalized intelligent automation consists of our range of innovative automatic pallet changing solutions and flexible manufacturing systems, supported by our proprietary SMT™ and ART™ technologies.

These cutting-edge technologies not only optimize performance with efficient management in time, but also contemplate the use of analytics and intelligent tools to make automated and intelligent decisions.

Digitalized intelligent automation solutions enable machinists to embrace smart manufacturing to increase operational efficiency and productivity, optimize energy and staffing costs, and achieve 24/7 unmanned production, thereby significantly boosting ROI. It provides with flexibility for end-to-end case management success.

Meanwhile, our proprietary technologies provide real-time and remote updates for manufacturers to embrace automation with no unexpected down-time. Besides, it can support manufacturers to diminish non-productive time and enhance productivity.







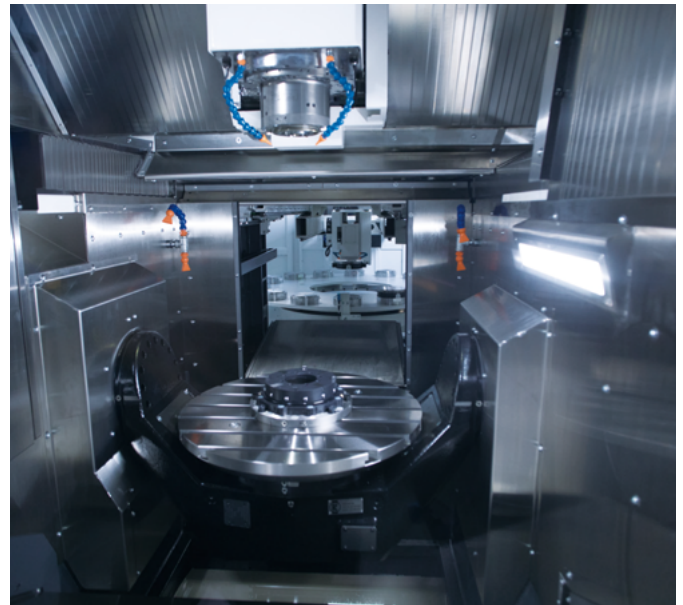
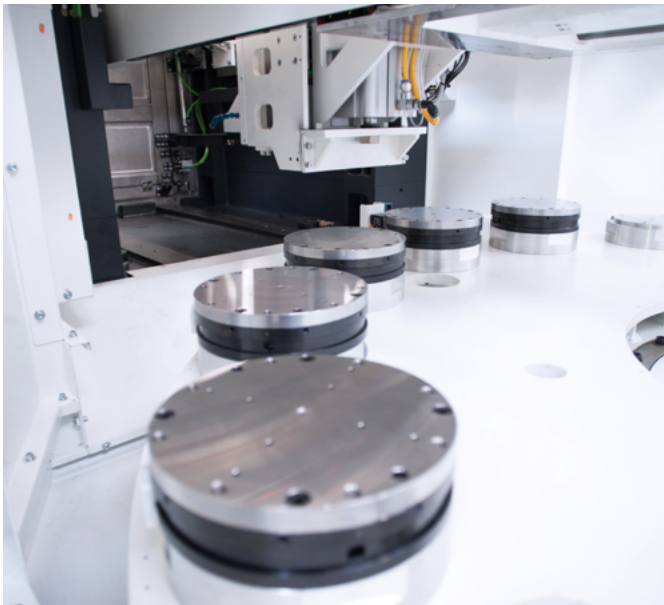

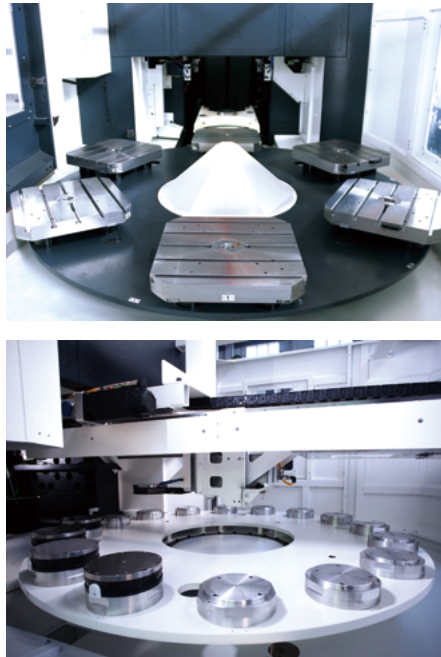
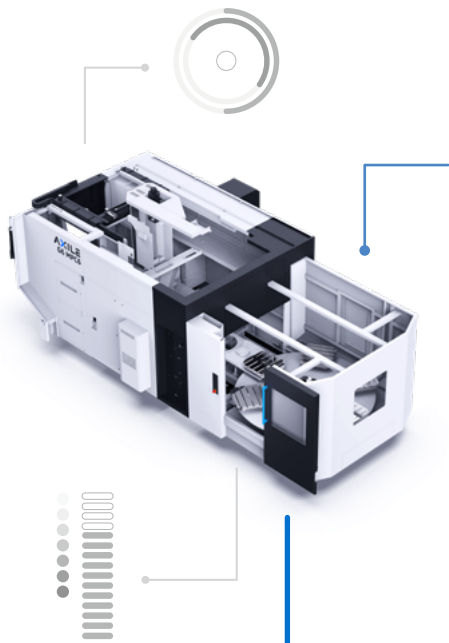

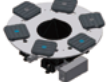
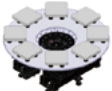
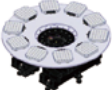

Using the OPC UA protocol and compatible with the UMATI (universal machine technology interface) platform, AXILE digitalized intelligent automation solutions can be integrated into a whole ecosystem of third-party products, solutions and systems.

AXILE Digitalized Intelligent Automation is able to support manufacturers as they work through some of the most difficult challenges and where we can develop smart manufacturing processes in collaboration with.

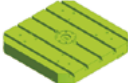
It also redefines the workforce, empowering human talent and digital workers in the future.



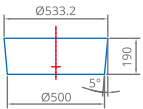
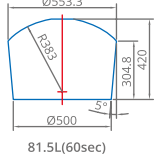
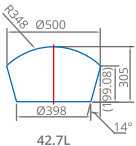
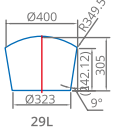
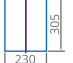

	Motorized Pallet Changer				Robotic Pallet Changer									
	MPC2	MPC2 + FMS	MPC FLEX	MPC6	RPC8	RPC10	RPC16	RPC20						
Loader type														
Magazine														
Pallet size	☒ 500 mm ☒ 19.7 in 				☒ 398 mm ☒ 15.7 in 				☒ 320 mm ☒ 12.6 in 		Ø210 mm Ø8.3 in 		Ø148 mm Ø5.8 in 	
Max. workpiece size	Ø500x190 mm Ø19.7x7.5 in 		Ø500x420 mm (*Ø500x480 mm) Ø19.7x16.5 in (*Ø19.7x18.9 in) 		Ø500x305 mm Ø19.7x12 in 		Ø400x305 mm Ø15.7x12 in 		Ø230x305 mm Ø9.1x12 in 		Ø160x250 mm Ø6.3x9.8 in 			
Max. weight	400 kg 881.8 lbs				220 kg 485 lbs		220 kg 485 lbs		98 kg 261.1 lbs		30 kg 66.1 lbs			

LOADER RPC COMPACT

Max Workpiece Capacity	84 positions for workpieces
Dimension	Ø100x100 mm
Max Workpiece Loading	8 kg
Max Workpiece Capacity	32 positions for workpieces
Dimension	Ø150x170 mm
Max Workpiece Loading	25 kg



FMS

Machine can be integrated in a 12-pallet FMS system.

Dimension is 500x500mm per machine.

It is expandable to 24, 36 or more per customer's need.

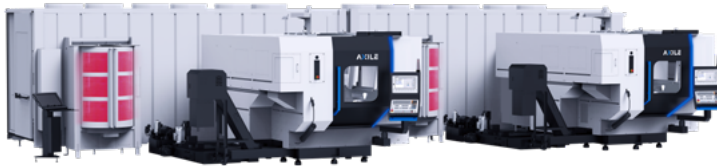
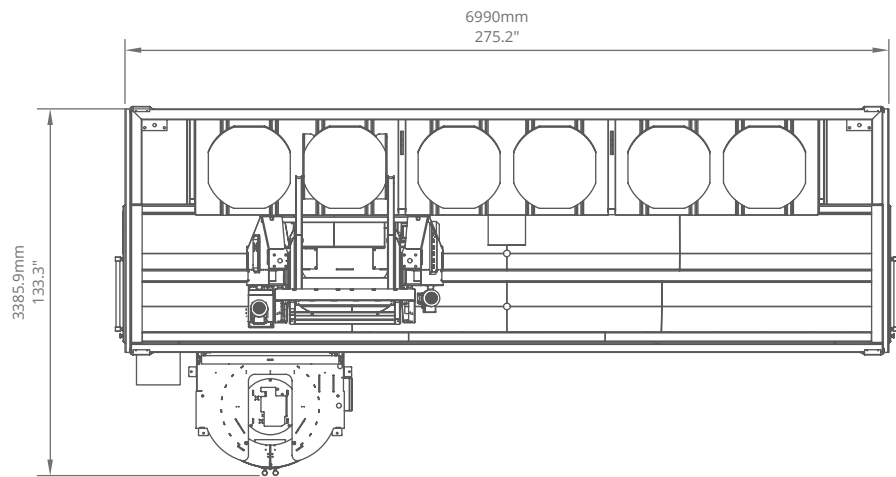

MPC HEAVY DUTY

Available for large size (up to 1200 mm diameter) and heavy loads (up to 2.5 tons capacity). Possible customization of the number of pallets available



MPC FLEX

Our optimized storage capacity within a reduced footprint!

With G6 MPC FLEX our customers can store up to 24 pallets dimension 500x500 mm while keeping operator access to machining area completely free to perform any type of settings.

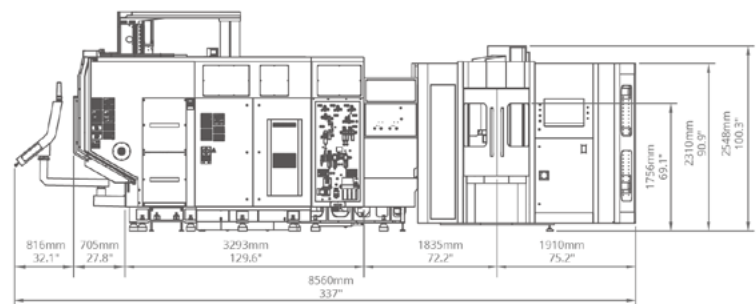
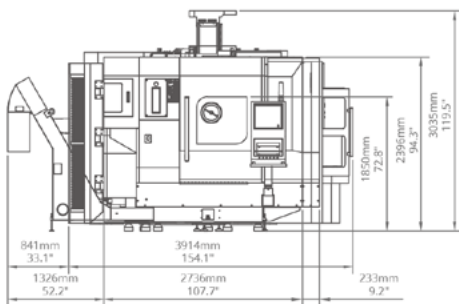
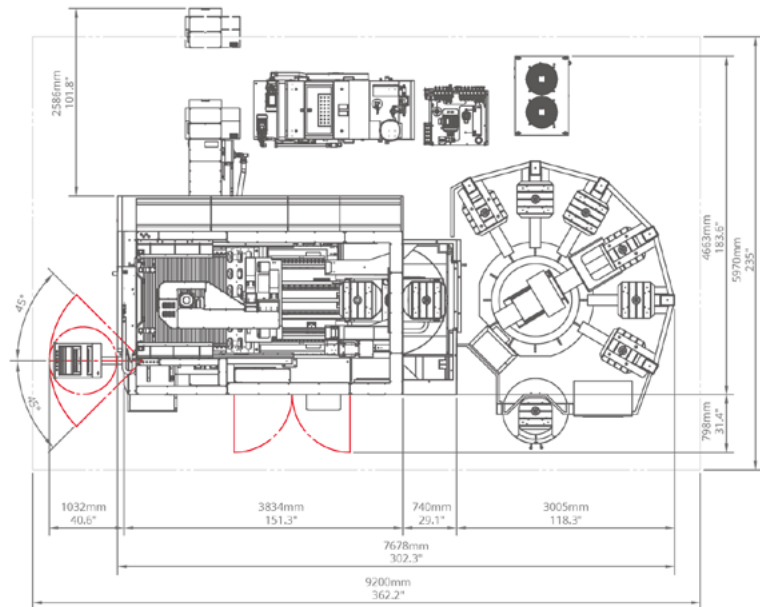

* All Specifications are subject to change without notice.



AXILE MACHINE



info@axilemachine.com



www.axilemachine.com

